

# TRADESMAN® DUAL ROPED

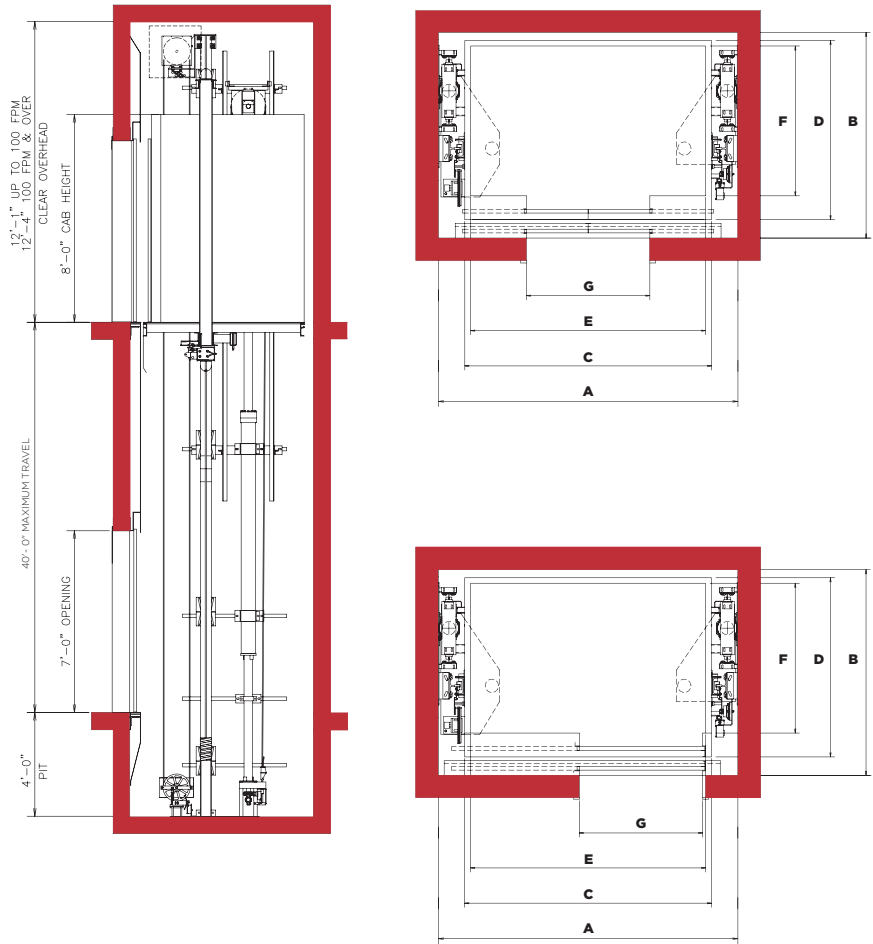
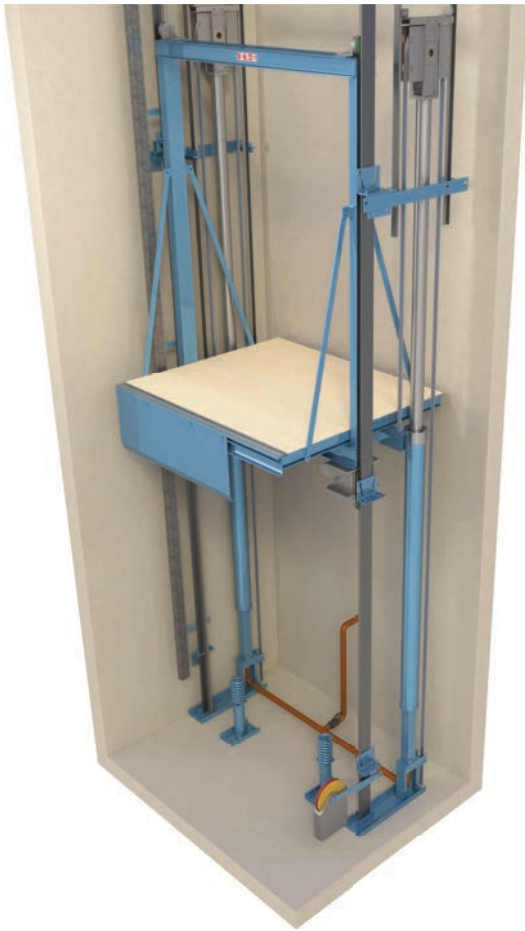

PASSENGER DUAL ROPED					FRONT OPEN ONLY		
Type	Capacity (lbs)	Hoistway	Platform	Inside Cab	Door Type	Door Width G	Maximum Travel
		Width x Depth A x B	Width x Depth C x D	Width x Depth E x F			
Passenger	2000	7'-8" x 5'-10"	6'-0" x 5'-1"	5'-8" x 4'-3"	Single Speed	3'-0"	40'-0"
	2500	8'-8" x 5'-10"	7'-0" x 5'-1"	6'-8" x 4'-3"	Single Speed	3'-0"	40'-0"
	2500	8'-8" x 5'-10"	7'-0" x 5'-1"	6'-8" x 4'-3"	Center Opening*	3'-6"	40'-0"
	3500	8'-8" x 6'-11"	7'-0" x 6'-2"	6'-8" x 5'-4"	Single Speed	3'-6"	40'-0"
	3500	8'-8" x 6'-11"	7'-0" x 6'-2"	6'-8" x 5'-4"	Center Opening*	3'-6"	40'-0"

## NOTES:

- 2000-lb. car complies with NEII recommendations for car to accommodate wheelchair.
- 3500-lb. and larger cars comply with NEII recommendations for car to accommodate ambulance size stretcher when equipped with single slide doors.

\*Center parting doors do not allow stretchers.

